

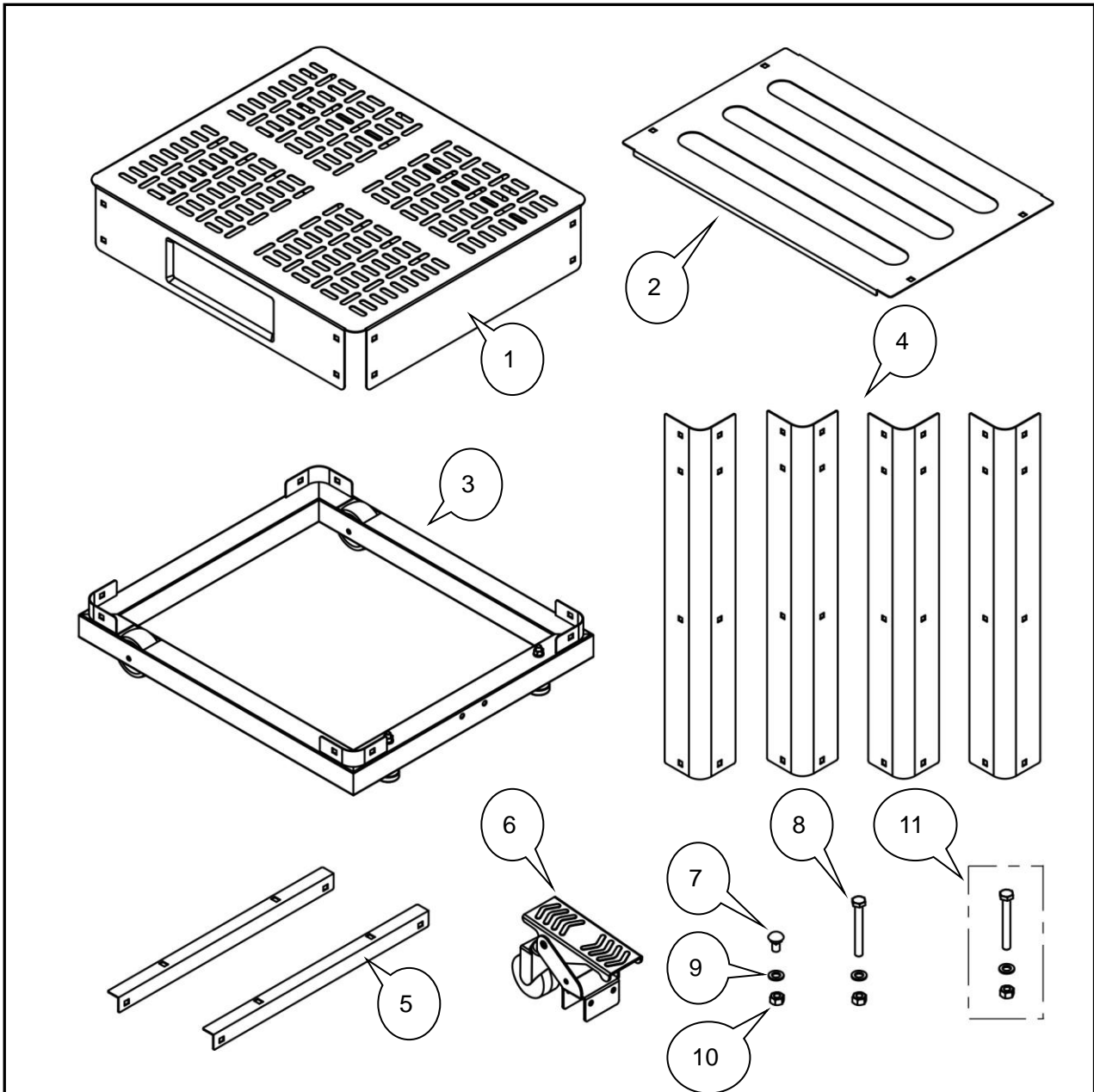

## ORIGINAL INSTRUCTIONS



- |                         |                                       |
|-------------------------|---------------------------------------|
| 1. Tabletop             | x1                                    |
| 2. Shelf                | x1                                    |
| 3. Base assembly        | x1                                    |
| 4. Leg                  | x4                                    |
| 5. Support bracket      | x2                                    |
| 6. Pivot wheel assembly | x1                                    |
| 7. M8X16 Carriage bolt  | x32                                   |
| 8. M8X60 Hex head bolt  | x2                                    |
| 9. 8mm Flat washer      | x34                                   |
| 10. M8 Hex nut          | x34                                   |
| 11. M8X60 Hex head bolt | x4 (For mounting power tool to stand) |
| 8mm Flat washer         | x4                                    |
| M8 Hex nut              | x4                                    |

## SAFETY RULES AND WARNINGS

**WARNING:** Failure to follow these rules may result in serious personal injury.

1. This product is designed to be used as a stand for bench type power tools. The stand will support up to 100kg. Any misuse or abuse can result in product damage or personal injury.
2. Do not stand on the work table. It is unsafe to climb, sit or stand on the stand. Do not use the support extensions as a ladder or scaffolding.
3. Properly secure the power tool to the stand before operation. Follow the mounting instructions carefully. Fasten the tool to the tabletop securely as instructed.
4. Place the stand on a flat and level surface to prevent rocking or tipping.
5. Make sure the stand is firmly on the floor; the foot pedal is down and the wheel is raised before use.

## ASSEMBLY AND ADJUSTMENT

1. Place the tabletop on the floor, attach a leg to the corner of the table top using four carriage bolts, flat washers, and hex nuts. Repeat the steps to attach other legs.

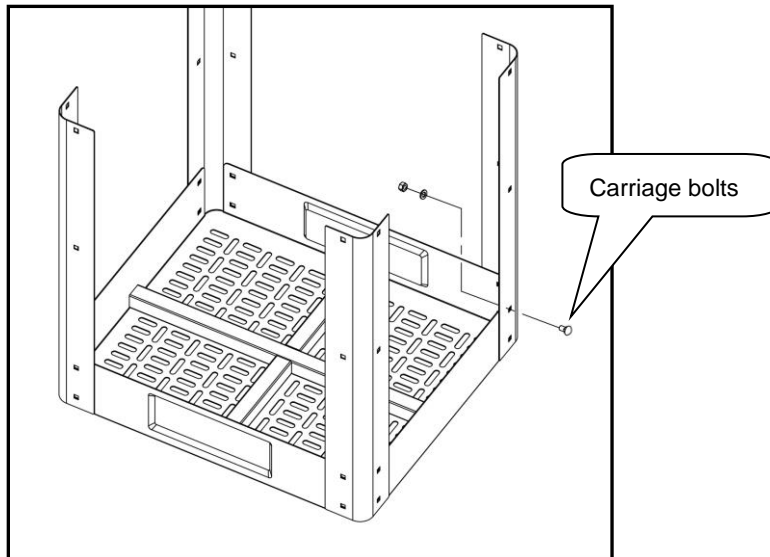

2. Attach the tabletop and leg assembly to base assembly using carriage bolts, flat washers, and hex nuts.

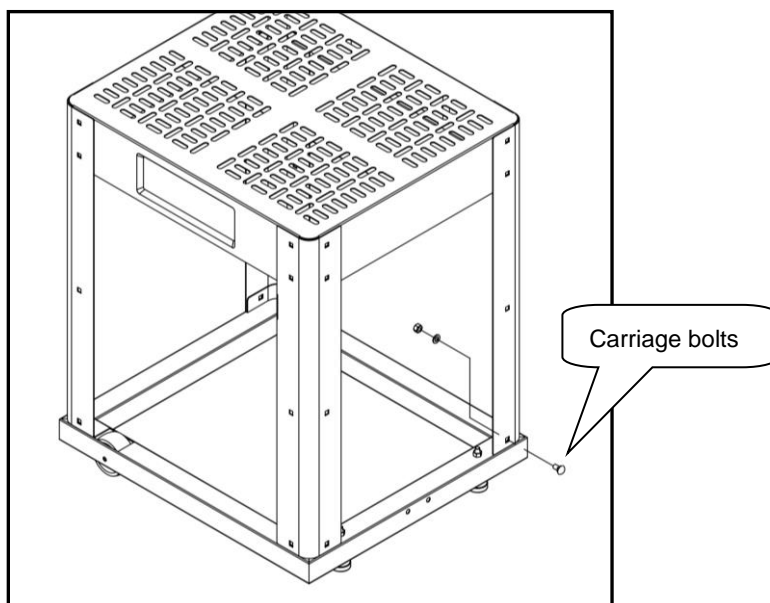

3. Attach the pivot wheel assembly to the base using two M8X60 hex head bolts, flat washers, and hex nuts.

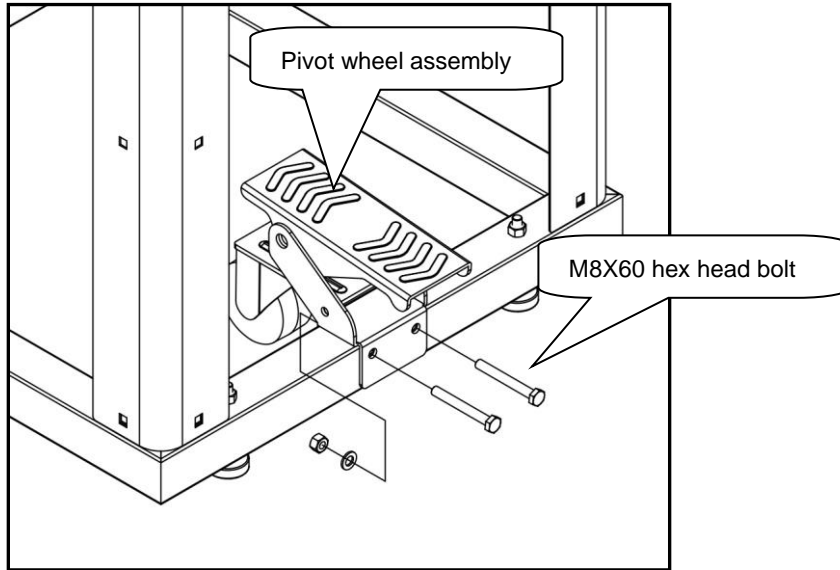

4. Attach the two support brackets and the shelf using carriage bolts, flat washers, and hex nuts.

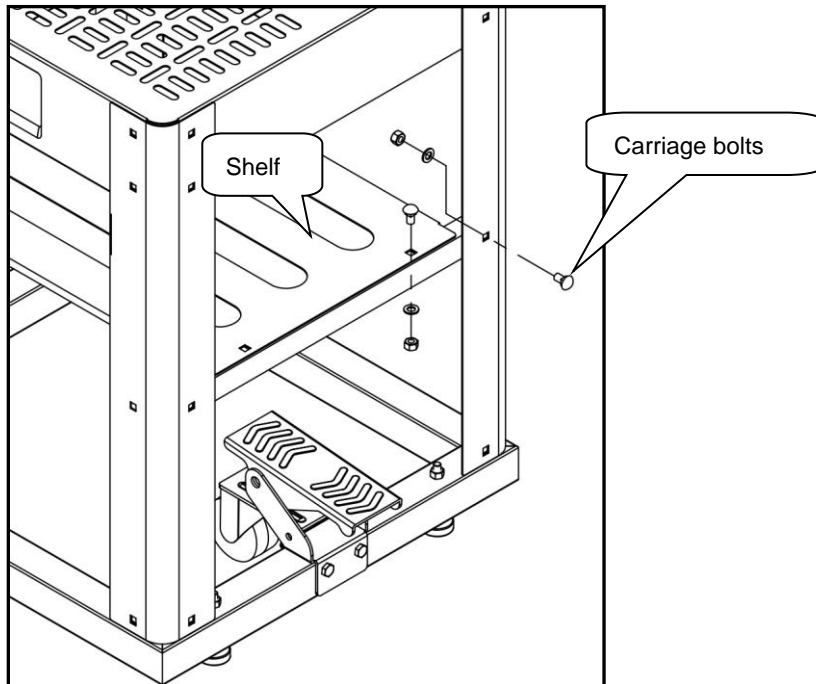

5. Attach the power tool to the stand using the M8X60 hex head bolts, flat washers, and hex nuts.  
The tool must be properly positioned and secured to ensure stability and to prevent inadvertent tipping.

**Note:** Once assembly is complete and before first use, check each bolt and nut to ensure it is properly tightened, and that all mechanisms operate properly.

### To move mobile wheels:

Step on the foot pedal to unlock and lift stand. Move to a new location. Push the foot pedal up, dropping the base into a locked position before you resume operating.

# ASSEMBLY DIAGRAM

